



FPZ, Inc
 150 N. Progress Drive
 Saukville, WI 53080 - U.S.A.
 Tel. (262) 268-0180
 Fax (262) 268-0415
 E-mail usa@fpz.com

REGENERATIVE BLOWERS - VACUUM
SCL K03 / K04 / K05 / K06
TD SERIES - MOR RANGE
 SN 1936-3 1/2

TECHNICAL CHARACTERISTICS

- Aluminium alloy construction
- Smooth operation
- High efficiency impeller
- Maintenance free
- Mountable in any position

OPTIONS

- Special voltages (IEC 38)
- Surface treatments

ACCESSORIES

- Inlet and/or inline filters
- Additional inlet/outlet silencers
- Safety valves
- Flow converting device
- Optional connectors

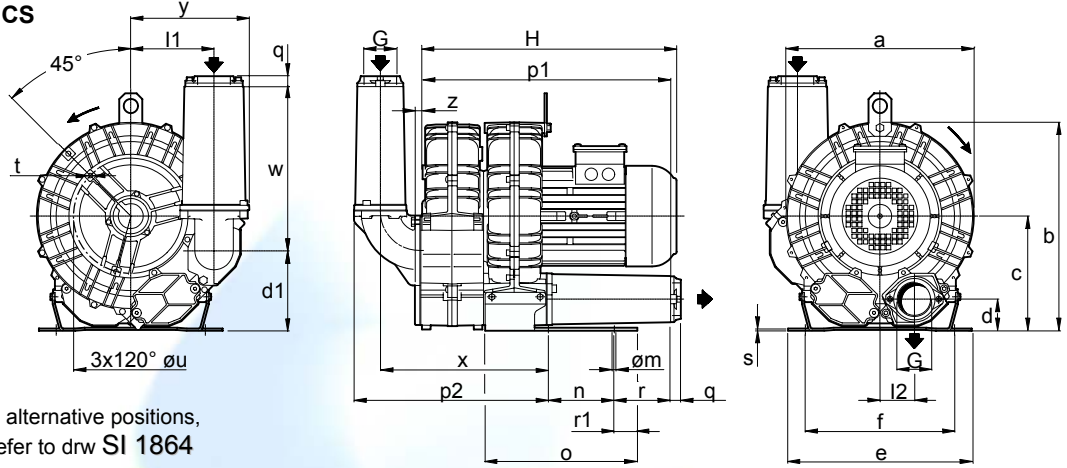

Possible alternative positions,
 please refer to drw SI 1864

Dimensions in inches.
 Dimension for reference only.

Model	a	b	c	d	d1	e	f	G	l1	l2	m	n	o	p1	p2	q	r	r1	s	t	u	w	x	y	z
K03-TD	9.49	10.55	5.79	1.69	4.09	9.06	8.07	1" 1/4 NPT	4.09	1.69	0.39	3.27	5.59	8.19	8.46	0.71	2.95	0.51	0.16	M6	5.51	7.40	7.09	5.75	0.47
K04-TD	11.22	12.40	6.77	1.93	4.76	10.04	8.86	1" 1/2 NPT	4.84	2.01	0.47	3.74	6.73	12.44	10.00	0.71	2.76	0.59	0.16	M6	6.89	7.40	8.43	6.81	0.71
K05-TD	12.87	14.37	7.87	2.13	5.51	12.60	10.24	2" NPT	5.71	2.36	0.59	4.53	10.43	16.85	13.39	0.71	3.86	1.57	0.16	M8	7.87	11.26	11.54	8.11	0.75
K06-TD	14.80	16.54	9.13	2.32	6.69	12.80	11.42	2" NPT	5.94	2.87	0.59	5.51	10.43	19.92	13.94	0.71	5.35	0.75	0.16	M8	9.45	11.26	12.13	8.27	0.75

Model	Maximum flow cfm		Installed power Hp		Maximum differential pressure Δp (In Hg)		Noise level Lp dB (A) ⁽¹⁾		Overall dimensions H Inches	Weight Lbs
	60 Hz 3500 rpm	50 Hz 2900 rpm	60 Hz 3500 rpm	50 Hz 2900 rpm	60 Hz 3500 rpm	50 Hz 2900 rpm	60 Hz 3500 rpm	50 Hz 2900 rpm		
K03-TD	52	43	1 1/2	1 1/2	6.6	5.9	67.6	65.6	14.88	43.43
			2	2	5.1	7.0	70.6	68.6		
K04-TD	99	82	3	3	8.8	8.1	71.6	69.6	15.91	58.40
			3	3	5.1	7.0	72.6	70.6		
K05-TD	153	127	4	4	7.7	9.9	74.1	72.1	17.32	79.40
			5 1/2	5 1/2	11.0	11.8	75.6	73.6		
			5 1/2	5 1/2	5.9	8.8	74.6	72.6		
K06-TD	222	184	7 1/2	6 1/4	9.2	10.3	75.6	73.6	19.29	108.50
			10	8 1/3	11.8	11.8	76.6	74.4		
			10	8 1/3	11.8	11.8	76.6	74.4		

(1) Noise measured at 1 m distance with inlet and outlet ports piped, in accordance to ISO 3744.

- For proper use, the blower should be equipped with inlet filter and safety valve; other accessories available on request.
- Ambient temperature from +5° to +104°F.
- Specifications subject to change without notice.

F.P.Z. effepizeta s.r.l.
 Via F.lli Cervi 16/18
 20049 Concorezzo - (MI) - ITALIA
 Tel. +39 039 604 1820
 Fax +39 039 604 1296
 E-mail italia@fpz.com

FPZ UK LTD
 Grateley Business Park,
 Cholderton Road Grateley Andover
 HAMPSHIRE, SP11 8SH - UNITED KINGDOM
 Tel. +44 1264 889001
 Fax +44 1264 889003
 E-mail uk@fpz.com

F.P.Z. France S.a.r.l.
 P.A Europe - 10 rue d'Italie
 69780 - Mions - FRANCE
 Tel. +33 (0)472 50 13 13
 Fax +33 (0)472 50 03 40
 E-mail france@fpz.com

F.P.Z. GmbH
 Kilianstraße 142
 90425 Nürnberg - DEUTSCHLAND
 Tel. +49 (0)911 36 78 68-00
 Fax +49 (0)911 36 78 68-01
 E-mail deutschland@fpz.com

FPZ IBERICA S.L.
 Poligono Ind. Errota nave 5E
 20270 - ANOETA GIPUZKOA - ESPAÑA
 Tel. +34 943 653 942
 Fax +34 943 653 943
 E-mail iberica@fpz.com



REGENERATIVE BLOWERS - VACUUM
SCL K03 / K04 / K05 / K06
TD SERIES - MOR RANGE
 SN 1936-3 2/2

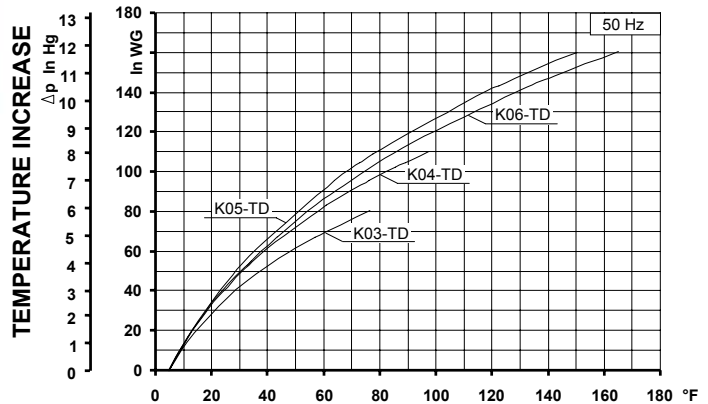
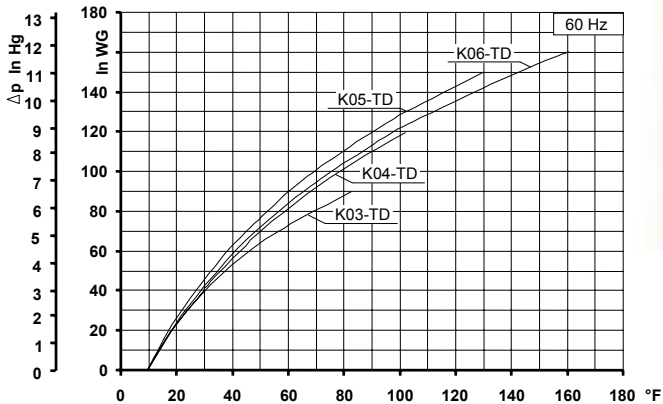
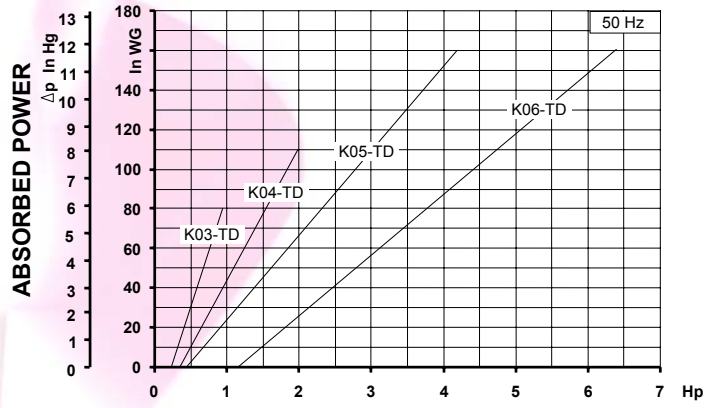
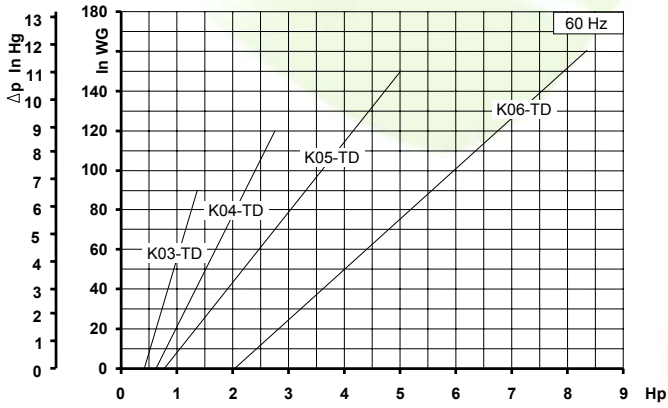
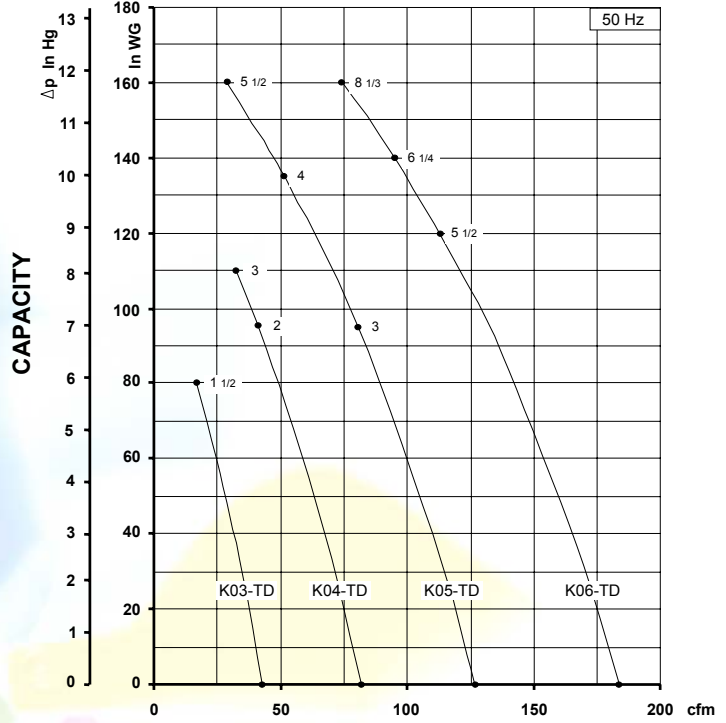
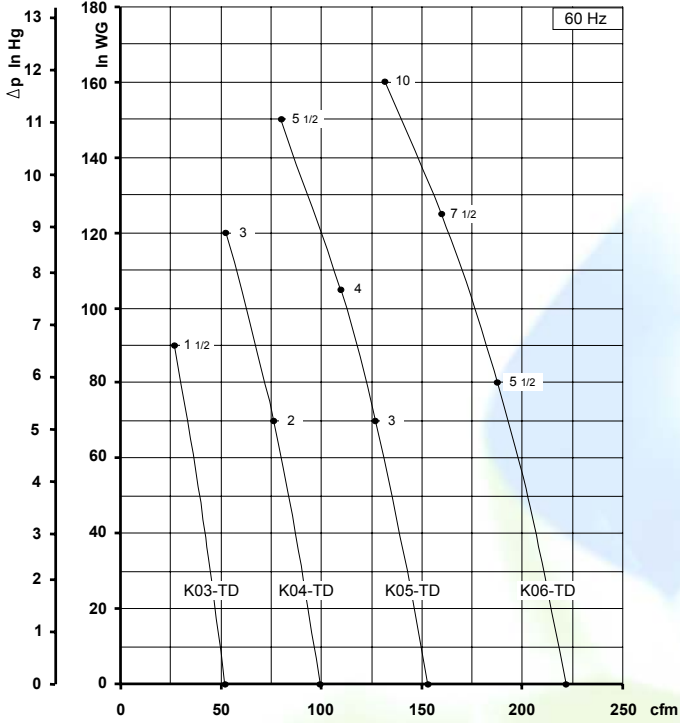

Curves refer to air at 68° F temperature, measured at inlet port and 29.92 In Hg atmospheric backpressure (abs).
 Values for flow, power consumption and temperature rise: +/-10% tolerance.
 Data subject to change without notice.