



**FPZ, Inc**  
 150 N. Progress Drive  
 Saukville, WI 53080 - U.S.A.  
 Tel. (262) 268-0180  
 Fax (262) 268-0415  
 E-mail usa@fpz.com

REGENERATIVE BLOWERS - PRESSURE  
**SCL K07R / K08R / K09 / K10 / K11 / K12**

**MD SERIES - MOR RANGE**  
 SN 1848-8 1/2

**TECHNICAL CHARACTERISTICS**

- Aluminium alloy construction
- Smooth operation
- High efficiency impeller
- Maintenance free
- Mountable in any position
- Recognized TEFC - **cURus** motor

**OPTIONS**

- Special voltages (IEC 38)
- Surface treatments

**ACCESSORIES**

- Inlet and/or inline filters
- Additional inlet/outlet silencers
- Safety valves
- Flow converting device
- Optional connectors

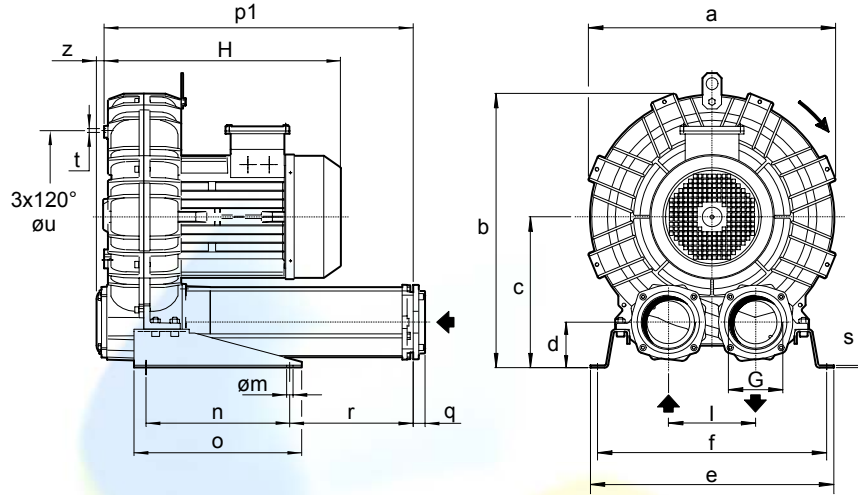

Dimensions in inches.  
 Dimension for reference only.

Model	a	b	c	d	e	f	G	l	m	n	o	p1	q	r	s	t	u	z
K07R-MD	16.69	18.94	10.59	3.23	18.43	17.24	2" NPT	6.10	0.51	11.81	13.78	16.46	0.71	1.70	0.20	M8	11.61	0.63
K08R-MD	17.99	19.61	10.59	3.23	18.82	17.64	2" NPT	6.10	0.51	11.81	13.78	16.46	0.71	1.70	0.20	M8	12.20	0.63
K09-MD	19.37	22.09	12.40	3.78	20.00	18.82	4" NPT	7.17	0.51	11.81	13.78	25.35	0.98	10.12	0.20	M8	14.17	0.63
K10-MD	20.31	22.56	12.40	3.78	20.00	18.82	4" NPT	7.17	0.51	11.81	13.78	25.35	0.98	10.12	0.20	M8	14.17	0.63
K11-MD	21.35	23.74	13.07	3.58	21.18	20.00	4" NPT	7.87	0.51	11.81	13.78	25.75	0.98	10.31	0.20	M8	15.35	0.63
K12-MD	21.57	23.85	13.07	3.58	21.18	20.00	4" NPT	7.87	0.51	11.81	13.78	25.87	0.98	10.31	0.20	M8	15.35	0.52

Model	Maximum flow Scfm		Installed power Hp		Maximum differential pressure Δp (In WG)		Noise level Lp dB (A) <sup>(1)</sup>		Overall dimensions H Inches	Weight Lbs
	60 Hz 3500 rpm	50 Hz 2900 rpm	60 Hz 3500 rpm	50 Hz 2900 rpm	60 Hz 3500 rpm	50 Hz 2900 rpm	60 Hz 3500 rpm	50 Hz 2900 rpm		
K07R-MD	129	107	3	3	68	87	73.5	71.5	16.14	101.40
			4	4	110	128	74.0	72.0	16.14	103.60
			5 ½	5 ½	150	170	74.5	72.5	16.14	111.50
			7 ½	7 ½	260	260	75.0	73.0	17.52	134.50
K08R-MD	168	139	5 ½	5 ½	85	110	76.2	74.2	16.14	116.90
			7 ½	7 ½	162	185	76.6	74.6	17.52	140.00
			10	10	240	260	77.0	75.0	17.52	151.00
			15	-	260	-	77.3	-	17.52	173.00
K09-MD	221	183	5 ½	5 ½	54	78	76.9	74.9	16.54	144.40
			7 ½	7 ½	120	143	78.0	76.0	17.95	167.60
			10	10	190	210	79.5	77.5	17.95	178.60
			15	15	290	290	80.5	78.5	19.29	200.60
K10-MD	275	228	7 ½	7 ½	85	110	79.9	77.9	17.91	170.90
			10	10	140	165	80.3	78.3	17.91	181.90
			15	15	245	270	81.4	79.4	19.29	203.90
			20	20	300	300	81.7	79.7	22.97	270.00
K11-MD	306	254	10	10	100	125	81.1	79.1	18.11	211.60
			15	15	190	220	81.4	79.4	19.49	232.60
			20	20	280	300	81.7	79.7	23.23	287.20
			25	-	300	-	82.0	-	23.23	353.30
K12-MD	336	278	15	15	100	180	82.3	80.3	19.61	240.30
			20	20	180	260	82.6	80.6	23.42	295.00
			25	-	250	-	82.9	-	23.42	361.00

(1) Noise measured at 1 m distance with inlet and outlet ports piped, in accordance to ISO 3744.

- For proper use, the blower should be equipped with inlet filter and safety valve; other accessories available on request.
- Ambient temperature from +5° to +104°F.
- Specifications subject to change without notice.



REGENERATIVE BLOWERS - PRESSURE  
**SCL K07R / K08R / K09 / K10 / K11 / K12**  
**MD SERIES - MOR RANGE**  
 SN 1848-8 2/2

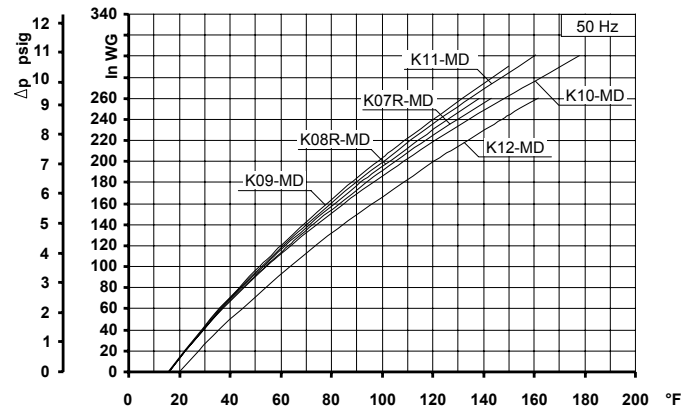
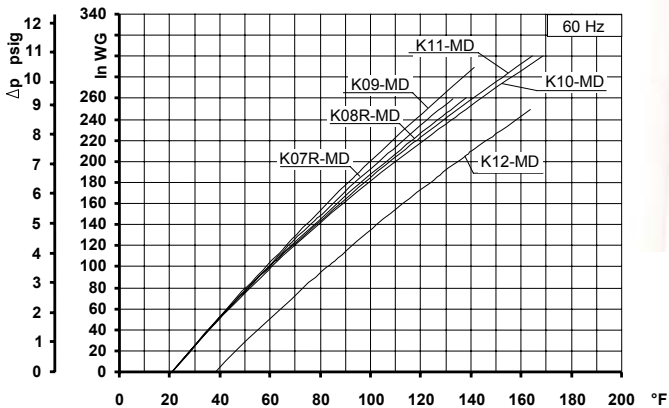
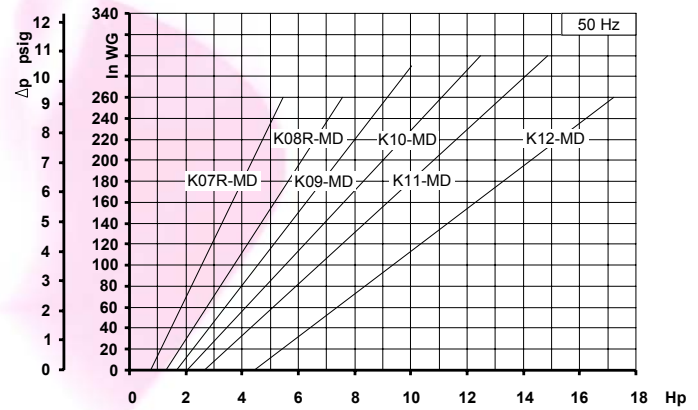
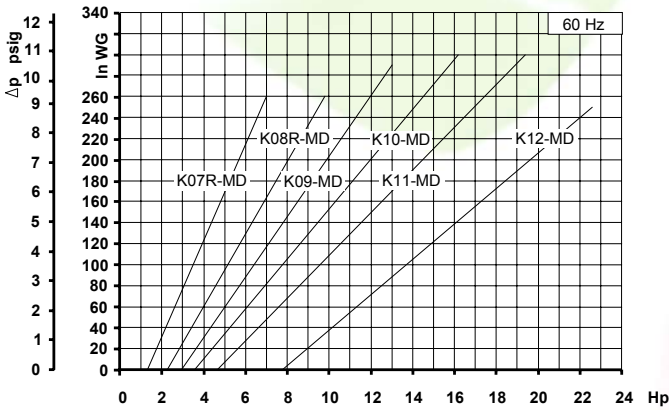
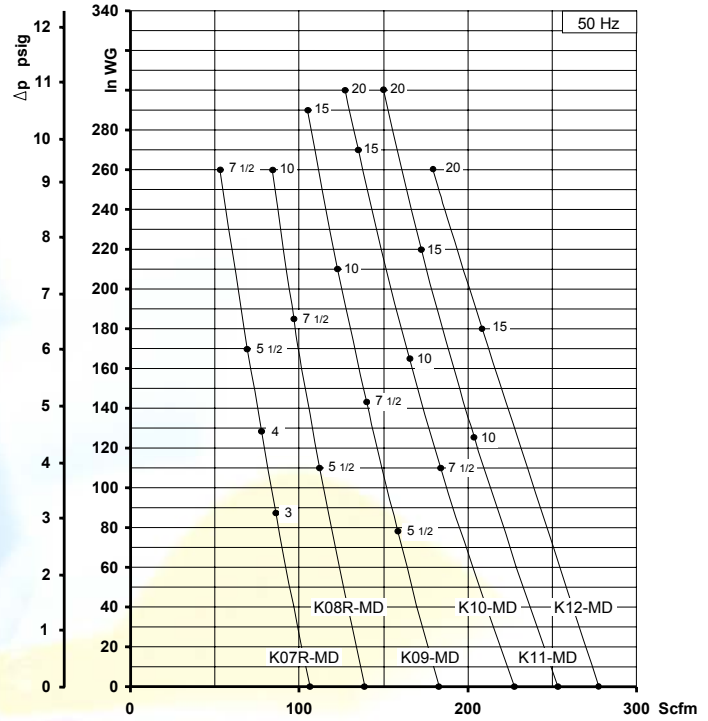
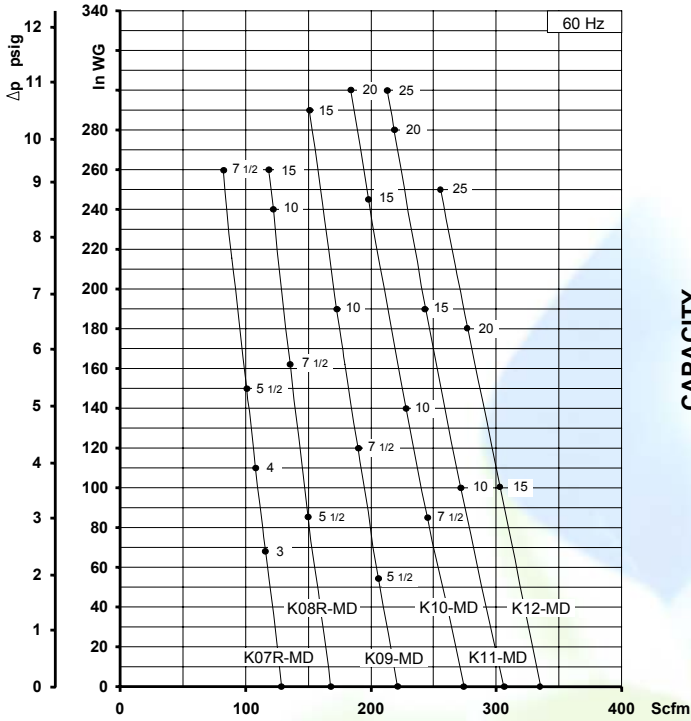

Curves refer to air at 68°F temperature and 29.92 In Hg atmospheric pressure (abs) measured at inlet port.  
 Values for flow, power consumption and temperature rise: +/-10% tolerance.  
 Data subject to change without notice.